

# Vacuum Oven

## TVO-2-2-A

PART ID: CTVA222-EA



Capacity	1.67 cu.ft. (47.2 liters)
Interior Dimensions (W x D x H)	12" x 20" x 12" 304 x 508 x 304 mm
Exterior Dimensions (W x D x H)	20.2" x 34.9" x 27.1" 513 x 887 x 689 mm
Unit Weight	182.2 lb (82.6 kg)
Shipping Weight	224 lb (102 kg)
Shelves	3 standard, 3 total
Maximum Weight Per Shelf	35 lb / 15.8 kg
Permitted Total Load	105 lb / 47.6 kg
Standard Door Gasket	Silicone Standard
Access Port	1" vacuum port (KF-25)
Controls	Watlow EZ-ZONE
Warranty	2 Year Limited Warranty
Interior Construction	300 series stainless steel
Exterior Construction	Painted Cold Roll Steel
Wall Clearance, Each Side	6.0" (152 mm)
Wall Clearance, Rear	12.0" (305 mm)
Vertical Clearance	12.0" (305 mm)
<b>Electrical, 50/60Hz, AC, 1Ø</b>	
Voltage	220V-240V
Full Load Amps	5.5
Nominal Power (watts @150°C)	750
Plug Supplied	EU 1-16P; NEMA 6-15P
<b>Energy Consumption (kWh/day)</b>	
At 80°C	13.9
At 150°C	16.7
At 220°C	26.5
<b>Temperature Range 10°C above ambient to 220°C</b>	
Heat-Up Time — Minutes to 80°C	70
Heat-Up Time — Minutes to 150°C	120
Heat-Up Time — Minutes to 220°C	175
Temperature Uniformity	+/- 6% of Set Point
Temperature Stability	+/- 0.2°C @ 150°C
Vacuum Display Range	1100 to 0.1 mTorr
Safety Certifications	UL 61010-1, EN 61010-1, CSA 61010-1, CE



MADE IN  
USA



C US CE



*We reserve the right to alter specifications at any time*

0740587 2/20

Contact Cascade TEK  
sales@cascadetek.com • cascadetek.com • +1-971-371-4096

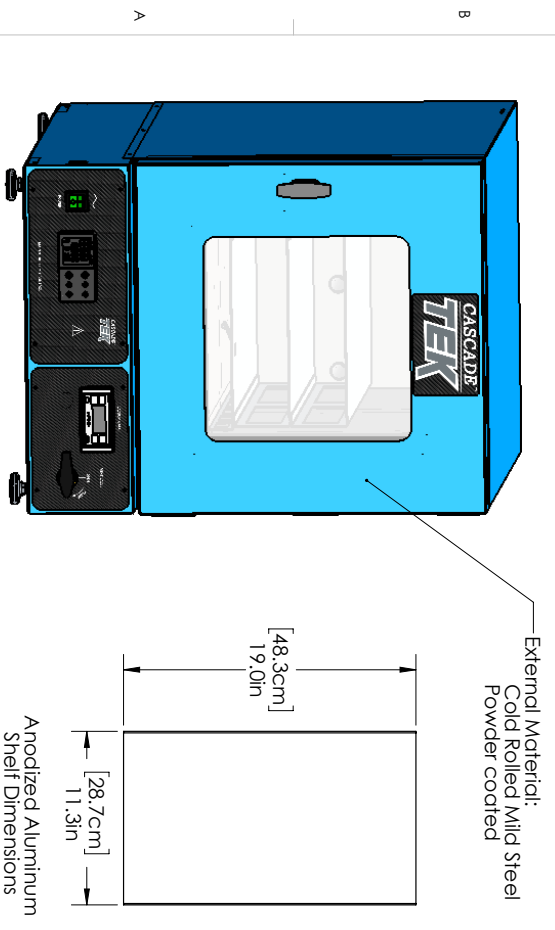
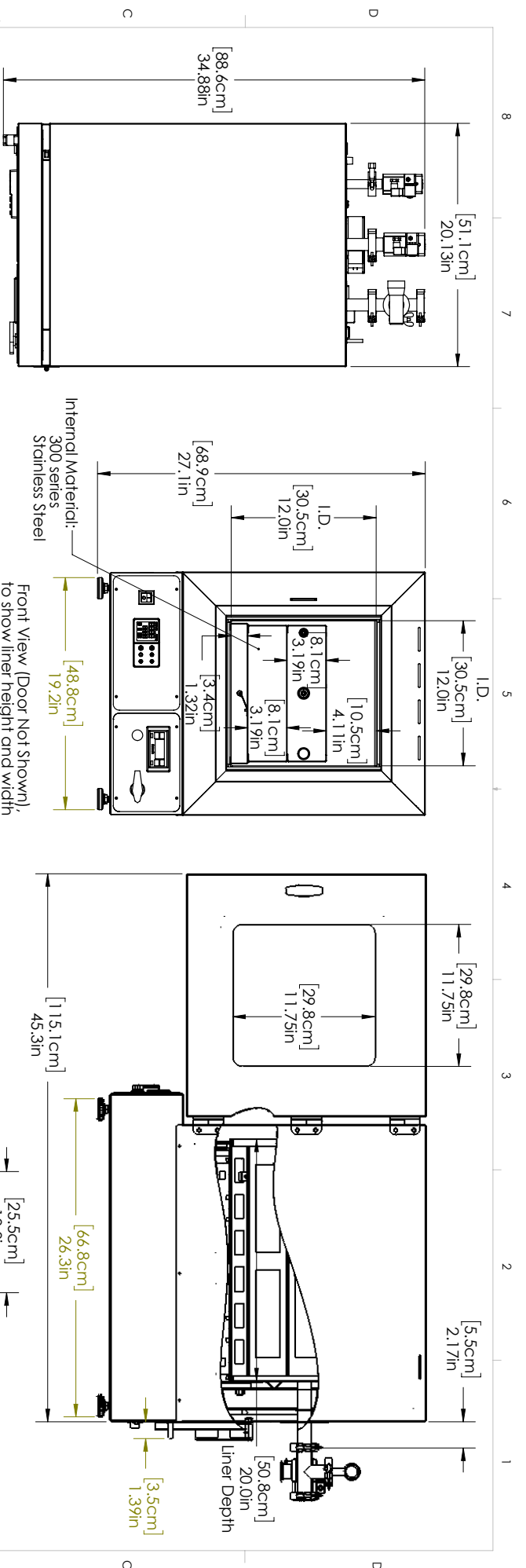

		<b>CASCADE TEK Solutions, LLC</b> 300 N 26th Ave. Cornelius, OR 97113 www.cascadetek.com	
		DRAWN: GJB NAME: GJB DATE: 10/20/2017	MODEL: TVO-2-2-A SIZE: B DWG. NO.: 9100950 SCALE: 1:8 WEIGHT:
THE INFORMATION CONTAINED IN THIS SHEETWORK IS THE PROPERTY OF CASCADE TEK SOLUTIONS, LLC. ANY REPRODUCTION IN WHOLE OR IN PART WITHOUT THE WRITTEN PERMISSION OF CASCADE TEK SOLUTIONS, LLC IS PROHIBITED.			
SHEET 1 OF 1		REV	