

Vacuum Oven

TVO-2-2-A

PART ID: CTVA223-EA

CASCADE™

TEK

Capacity	1.67 cu.ft. (47.2 liters)
Interior Dimensions (W x D x H)	12" x 20" x 12" 304 x 508 x 304 mm
Exterior Dimensions (W x D x H)	20.2" x 34.9" x 27.1" 513 x 887 x 689 mm
Unit Weight	182.2 lb (82.6 kg)
Shipping Weight	224 lb (102 kg)
Shelves	3 standard, 3 total
Maximum Weight Per Shelf	35 lb / 15.8 kg
Permitted Total Load	105 lb / 47.6 kg
Standard Door Gasket	Silicone Standard
Access Port	1" vacuum port (KF-25)
Controls	Watlow PM9 Plus
Warranty	2 Year Limited Warranty
Interior Construction	300 series stainless steel
Exterior Construction	Painted Cold Roll Steel
Wall Clearance, Each Side	6.0" (152 mm)
Wall Clearance, Rear	12.0" (305 mm)
Vertical Clearance	12.0" (305 mm)
Electrical, 50/60Hz, AC, 1Ø	
Voltage	220V-240V
Full Load Amps	5.5
Nominal Power (watts @150°C)	750
Plug Supplied	EU 1-16P; NEMA 6-15P
Energy Consumption (kWh/day)	
At 80°C	13.9
At 150°C	16.7
At 220°C	26.5
Temperature Range 10°C above ambient to 220°C	
Heat-Up Time — Minutes to 80°C	70
Heat-Up Time — Minutes to 150°C	120
Heat-Up Time — Minutes to 220°C	175
Temperature Uniformity	+/- 6% of Set Point
Temperature Stability	+/- 0.2°C @ 150°C
Vacuum Display Range	1100 to 0.1 mTorr
Safety Certifications	UL 61010-1, EN 61010-1, CSA 61010-1, CE



We reserve the right to alter specifications at any time

0740587 6/24

Contact Cascade TEK

sales@cascadetek.com • cascadetek.com • +1-971-371-4096

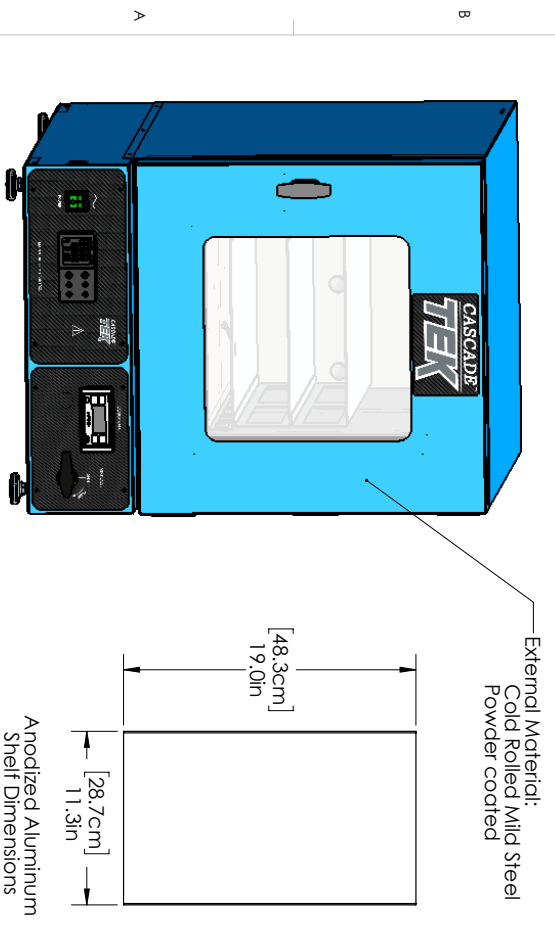
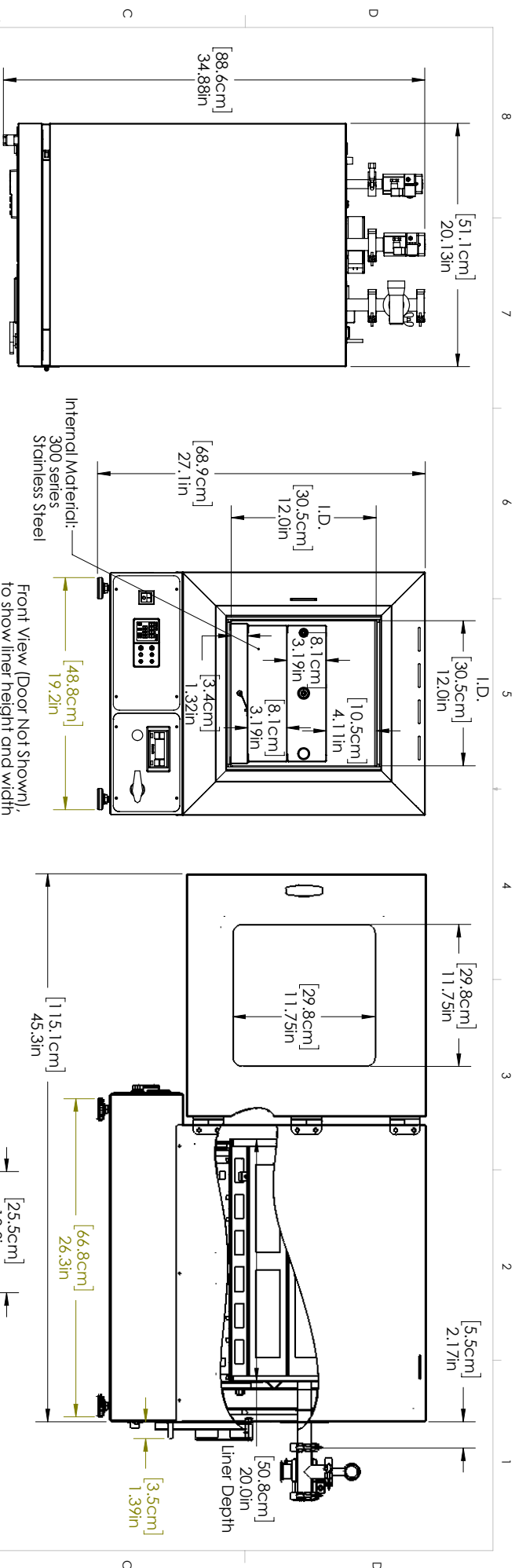

		NAME	DATE	MODEL:
		DRAWN	10/20/2017	TVO-2-2-A
Cascade TEK Solutions, LLC 300 N 26th Ave. Cornelius, OR 97113 www.cascadetek.com		SIZE	DWG. NO.	REV
		B	9100950	
SCALE: 1:8		WEIGHT:	SHEET 1 OF 1	

PROPRIETARY AND CONFIDENTIAL
 THE INFORMATION CONTAINED IN THIS SHEETWORK IS THE PROPERTY OF CASCADE TEK SOLUTIONS, LLC. ANY REPRODUCTION IN WHOLE OR IN PART WITHOUT THE WRITTEN PERMISSION OF CASCADE TEK SOLUTIONS, LLC IS PROHIBITED.